

**Good News Realty**  
**724-463-9000**

April 23, 2009

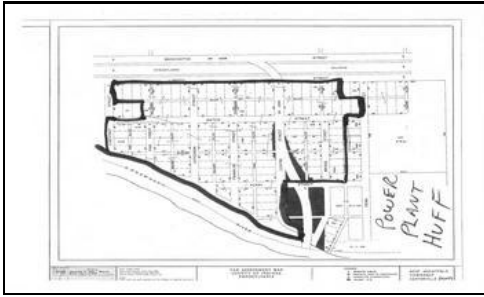

Address: **?? Huff Road**  
**New Florence, PA 15009**

List Price: **\$9,900**  
 Listing #: **0300063**

Status: **Active**  
 Subdivision: **None**

**8 acres near New Florence - extensive frontage on Conemaugh River - minimal taxes - First \$9,900 buys it!**

Comments: **Directions: From Philadepiha Street, take 954S, left onto 56 through Armagh, stay on 56 another 2.5 miles (just before river) turn right on Power Plant Road (Rt 32008), travel approx. 4.4 miles to "T", turn left on Rt 32009 (Huff Rd)-Land is on both sides just before the river. Yrly taxes are \$64.17**

Property Information		Property Features	
Est Acres:	<b>8.00</b>	Twp/Bor Taxes:	<b>18.93</b>
Lot Size:	<b>8 acres</b>	Sch Taxes:	<b>45.24</b>
Frontage Ft:	<b>0</b>	Tax Class:	<b>0</b>
Depth Ft:	<b>0</b>	Tax Yr:	<b>2009</b>
Elem School:	<b>United Elementary</b>	Water Type:	<b>None</b>
JH/Mdl School:	<b>United District</b>	Sewer Type:	<b>None</b>
Sr High School:	<b>United District</b>	Fuel Type:	<b>None</b>
Mun/Bor:	<b>West Wheatfield Township</b>	Flood:	<b>Flood Zone</b>
S-T-R:	<b>0 - 0 - 0</b>	Zoning:	<b>None</b>
Possession:	<b>Close</b>	Assessments:	<b>0</b>
Terms:	<b>0</b>	Parcel:	<b>41-020-139</b>
Abstract Loc:	<b>None</b>	Latitude:	
Assessed Value:	<b>580</b>	Longitude:	
Legal Description: <b>41-020-139, DB/Yr 2007, Pg/Doc 174772</b>			